

# Smart Cladding. Exsulite®

The smart facade cladding *you'll* love

Introducing **Exsulite**, a fully integrated lightweight thermal cladding solution.

*Exsulite* offers:

- Design Flexibility
- Full BCA Compliance\*
- CodeMark® Certified Full System
- Weatherproof Barrier System



\*Exsulite is CodeMark® certified as a fully integrated Building Systems in compliance with the Building Code of Australia (Volume Two, Class 1 and 10 residential buildings).

Learn more at [exsulite.com.au](http://exsulite.com.au)

**Exsulite®**  
Thermal Facade Cladding

# Exsulite® utilises multiple layers to build a strong, smart walling system

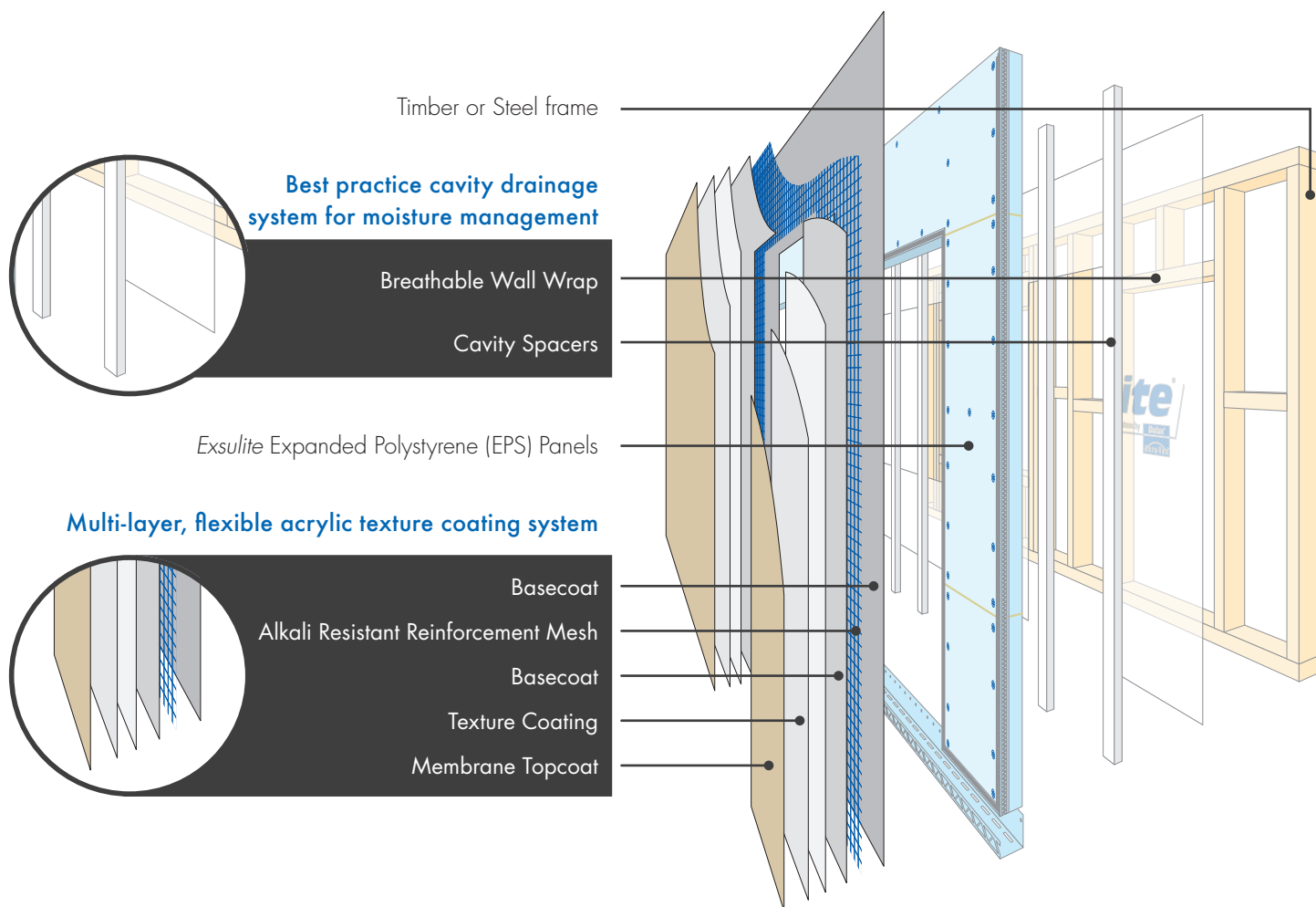

## Smart System. CodeMark® Certified†

Certified as a fully integrated facade system in compliance with the Building Code of Australia's criteria for:

- Energy Efficiency
- Weatherproofing
- Approved Componentry - No Substitution

Integration of System Design, Components and Installation is delivered through Exsulite Trained Installers providing quality assurance and peace of mind.



## Smart Cladding. Design Flexibility

Building Code of Australia (Volume Two, Class 1 & 10 residential buildings)



## Smart Cladding. BAL29 Certified†

Approved for use in bushfire prone areas



## Smart Cladding. Best practice cavity wall moisture drainage system

†Compliance to standard is relative to the Specification & Installation of the Full System as detailed in the relevant System Certification.

Learn more at [exsulite.com.au](http://exsulite.com.au) | 1300 662 841

Dulux AcraTex 1 Jeanes Street, Beverley SA 5009.

Dulux AcraTex is a division of DuluxGroup (Australia) Pty Ltd. ABN 67 000 049 427.

Dulux, AcraTex and Exsulite are registered trade marks of DuluxGroup (Australia) Pty Ltd.

CodeMark is a registered trade mark.

**Exsulite®**  
Thermal Facade Cladding